

**REMARKS: 1.CARGO COMPARTMENTS VENTILATION:**

- THE TTL NUMBER OF FANS - 21
- THE RATE OF AIR EXCHANGE :

- a) L/H AND TWND No1 - AT SEA - 10 V/H, IN PORT - 10 V/H
- b) L/Hs No 2...4 - AT SEA - 6 V/H, IN PORT - 6 V/H
- c) TWNDs No 2...4 - AT SEA - 10 V/H, IN PORT - 20 V/H

**2. REEFER SOCKETS :**

- AVAILABLE POWER - 208 kW
- TTL SOCKETS - 30
- SOCKETS TYPE - CCE-17 EUROPEAN STANDART 32A, 380V

**3. RO-RO DECK CAPABILITIES :**

- TRAILERS - 12/20' + 39/40' (TWND CLOSED); - 6/20' + 20/40' (TWND OPENED)
- TRUCKS (L/B/H - 6.7/2.5/2.4m) - 81 UNITS (TWND CLOSED); - 40 UNITS (TWND OPENED)
- CARS (L/B/H - 4.2/1.65/1.5m) - 232 UNITS (TWND CLOSED); - 117 UNITS (TWND OPENED)

**4. CAR DECK - S=2370 m<sup>2</sup>**

- Pd H/COVERS = 1.75 t/m<sup>2</sup>
- Pd W/DECK = 1.63 t/m<sup>2</sup>

**5. CONTAINERS CAPACITY (HOMOGENOUS LOADING WITH 20' CNTRS 8,12,16,24 AND 40 mtns)**

Wght of cntr.	8 mtns	12 mtns	16 mtns	24 mtns	40 mtns
L/h+twnd 2-4	285	285	285	240	185
L/h+twnd No1	20	20	20	20	14
Ro-Ro	46	46	46	46	
H/c 1 <sup>st</sup> tier	64	64	64	72	72
H/c 2 <sup>nd</sup> tier	59	26	10		
Upper deck	36	36	36	20	20
Ttl cntrs	510	477	461	398	291
Ttl weight	4.195	5.839	7.491	9.667	11.640

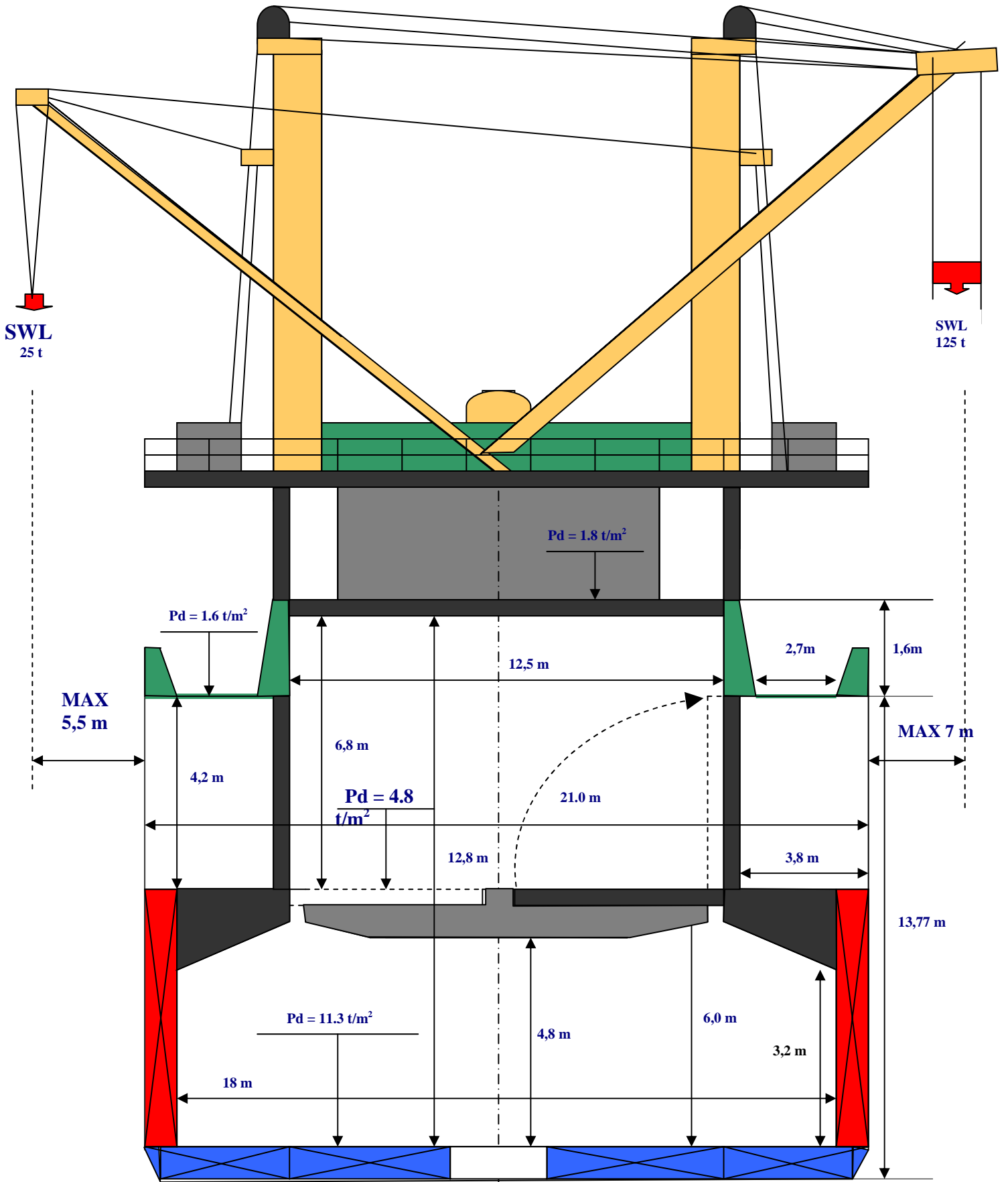

**LENGTH:** - HOLD – 36.0 m; -TWND - 35.0 m  
**COVERS:** - H/COVER–12.5x33.6 m; -  
 T/COVER-33.3x12.5 m

**REMARKS:** GENERAL VIEW AND MIDDLE SECTION OF THE  
 LOWER HOLD AND TWEENDECK No 4.  
 ALL DIMENSIONS ARE ABOUT.

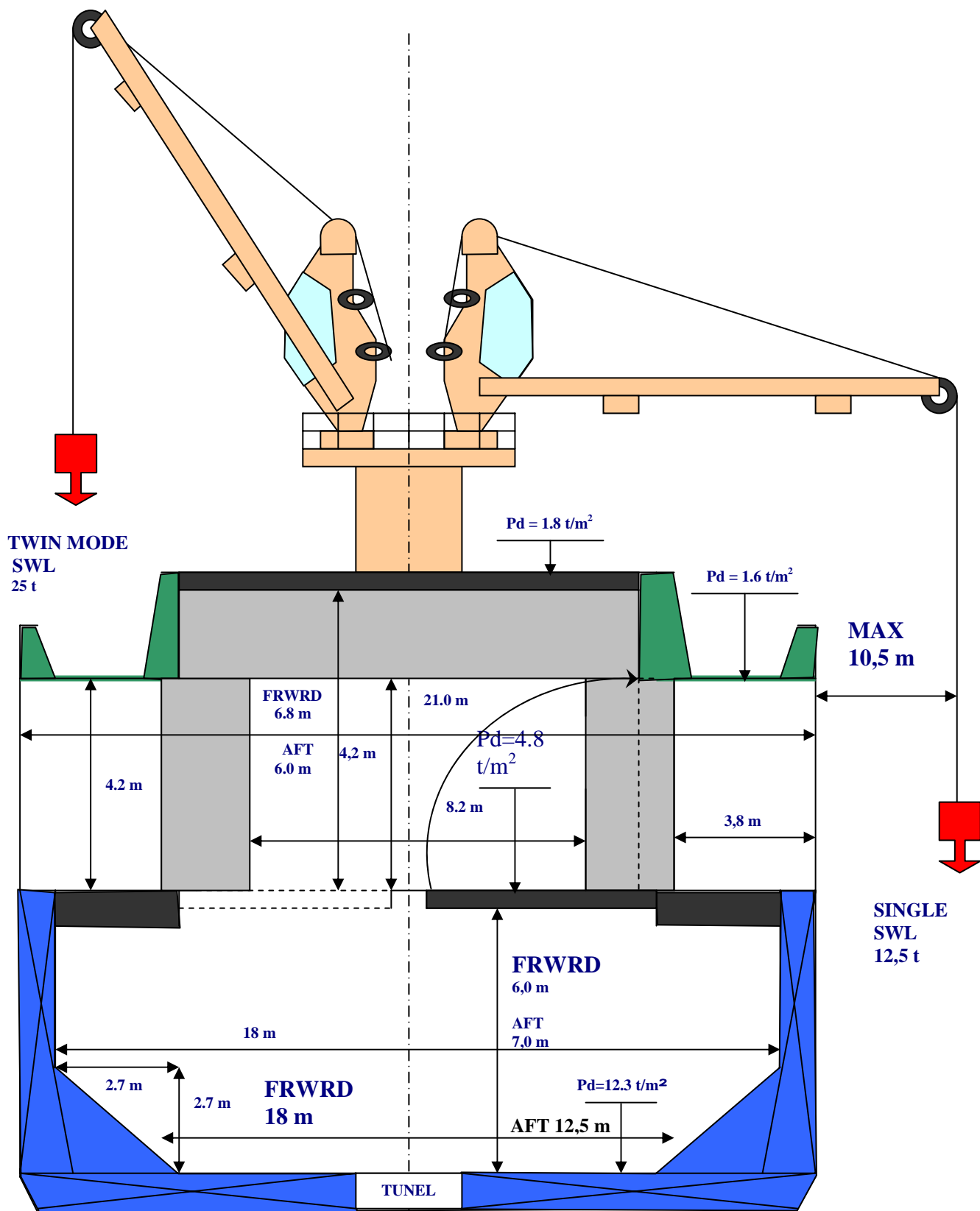

**LENGTH:** - HOLD - 16.6 m; -TWND - 13.0 m  
**COVERS:** - H/COVER-12.5x12.5 m; - T/COVER-12.5x12.5 m  
**CAPACITY:** - HOLD - 2010 m<sup>3</sup>; - TWND - 2876 m<sup>3</sup>  
**AREA :** - HOLD - 271 m<sup>2</sup>; TWND - 488 m<sup>2</sup>

**REMARKS:** GENERAL VIEW AND MIDDLE SECTION OF THE  
 LOWER HOLD AND TWEENDECK No 4.  
 ALL DIMENTIONS ARE ABOUT.

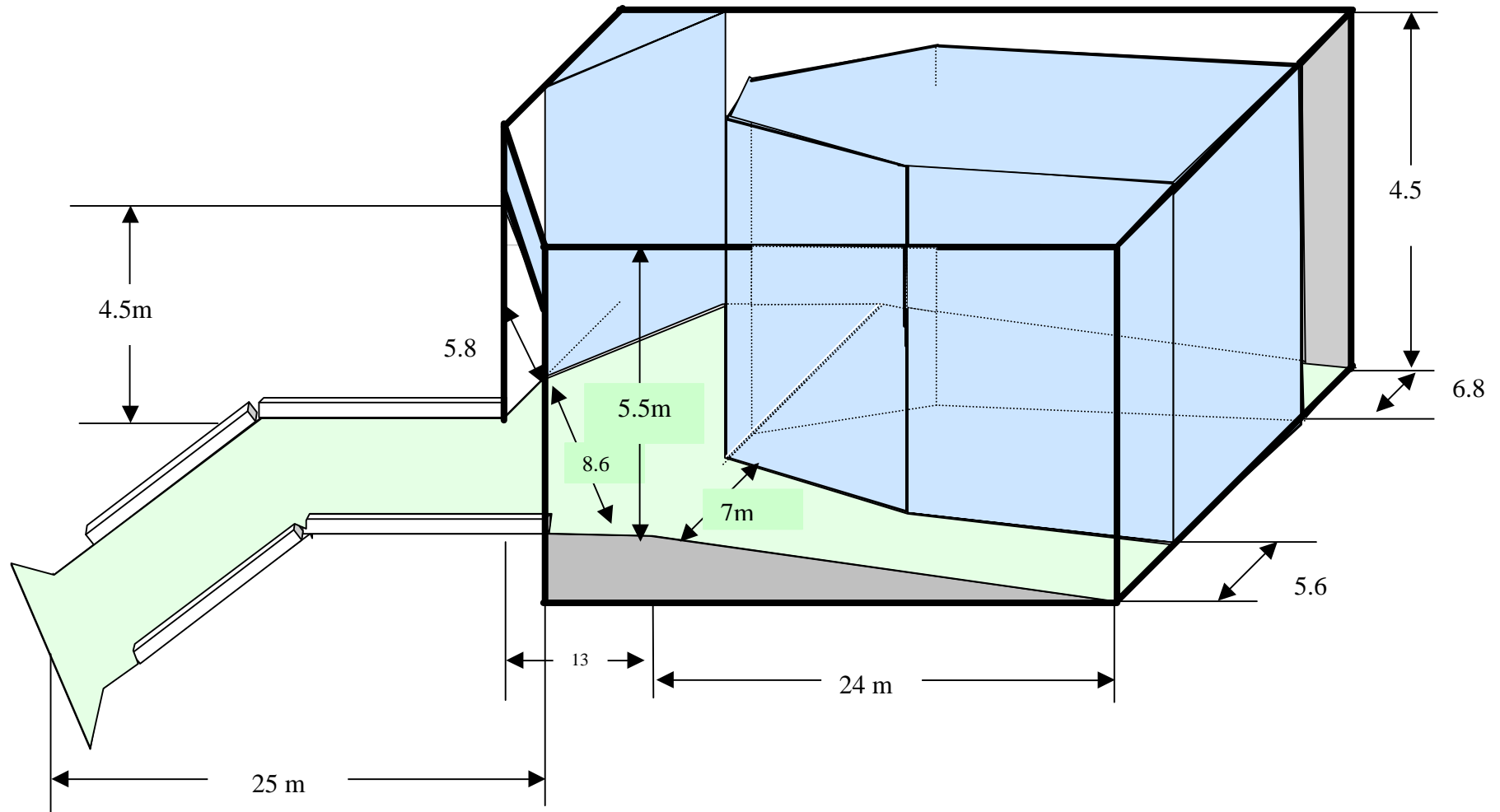

**GARAGE AND S/B QUARTER RAMP**

**GENERAL VIEW**

**ALL DIMENSIONS ARE ABOUT AND ONLY FOR INFORMATION**

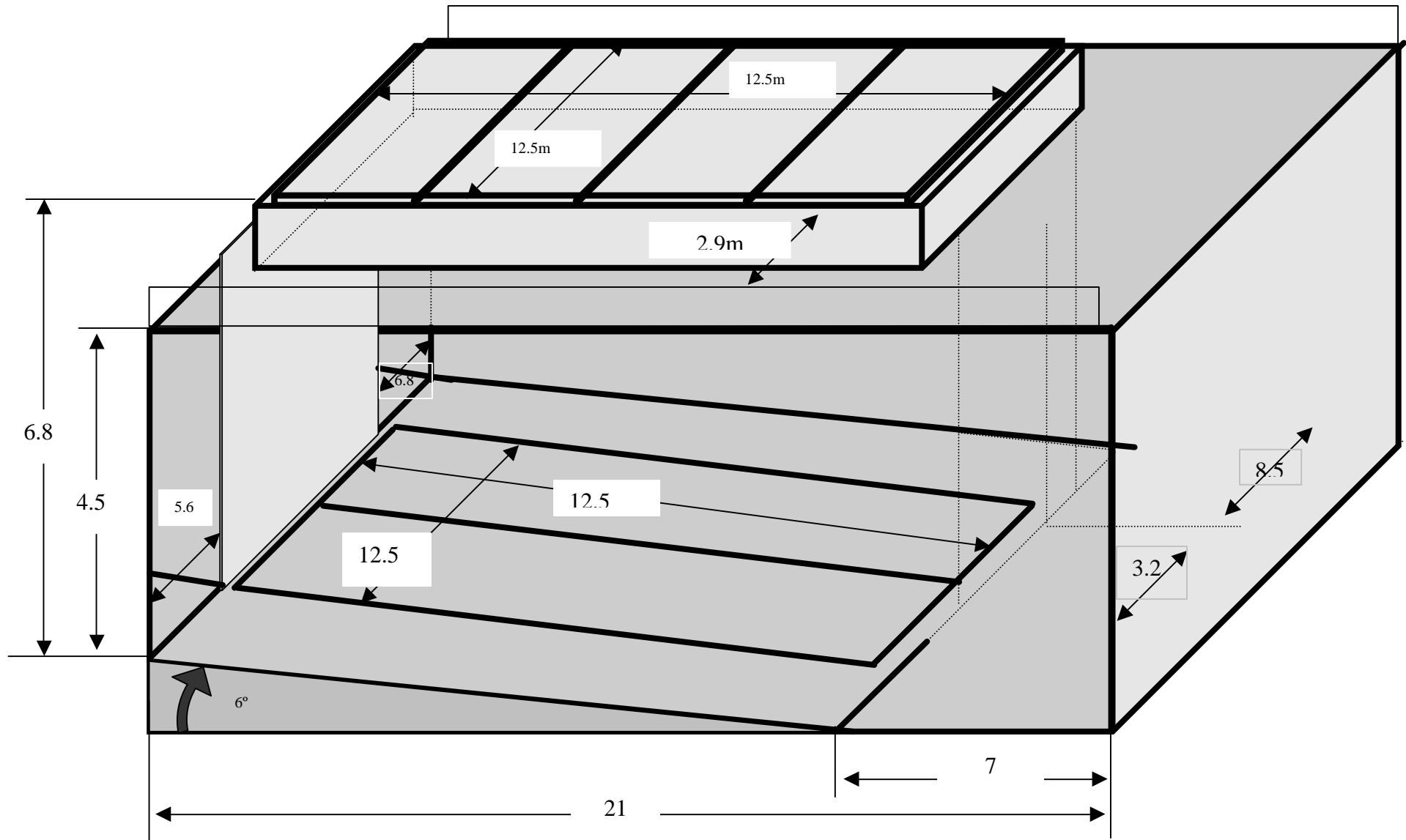

**WEATHER DECK/HATCH COVER/TWEENDECK No4**

**GENERAL VIEW**

**ALL DIMENSIONS ARE ABOUT AND ONLY FOR INFORMATION**

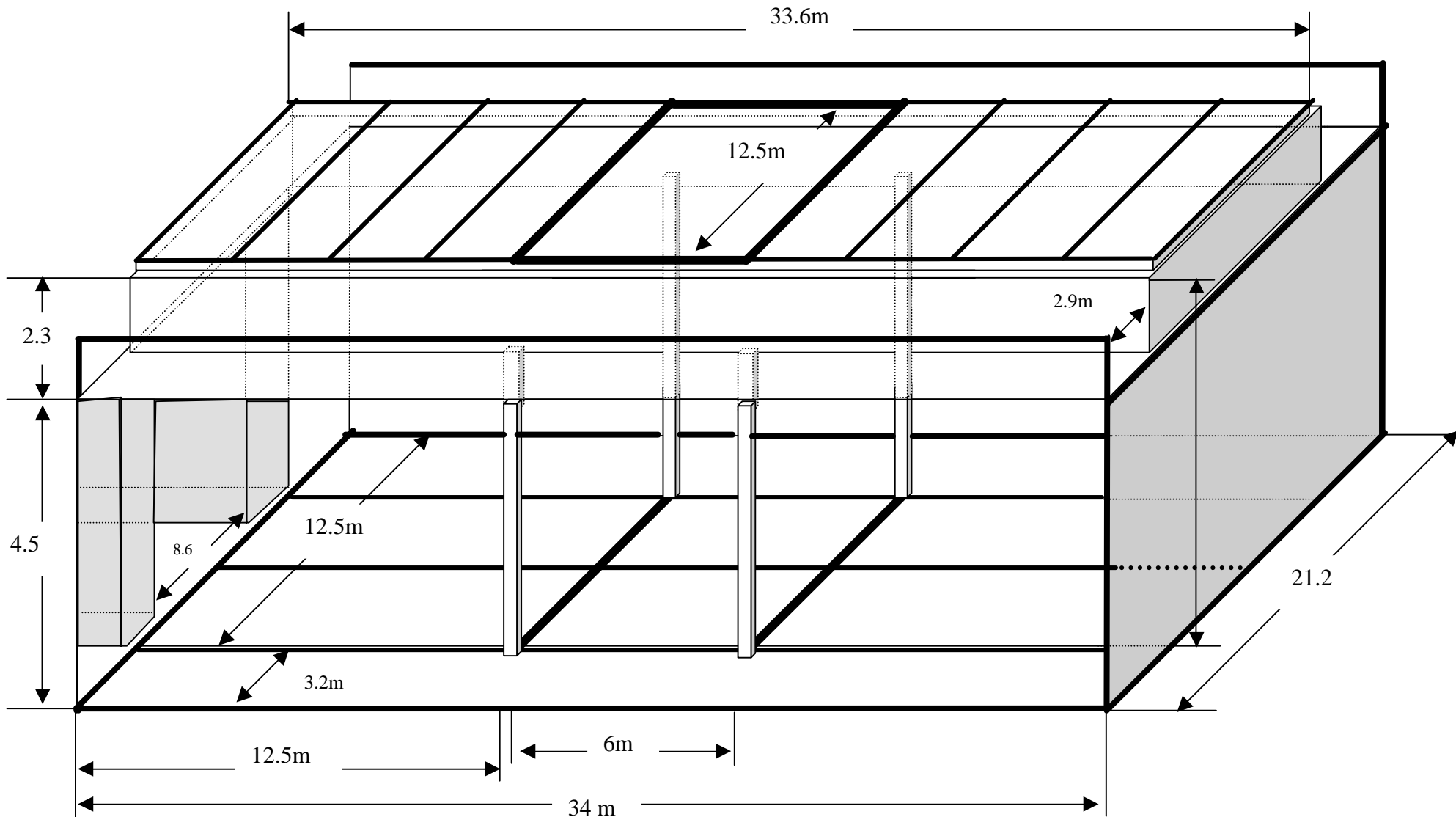

**WEATHER DECK/HATCH COVER/TWEENDECK No3**

**GENERAL VIEW**

**ALL DIMENSIONS ARE ABOUT AND ONLY FOR INFORMATION**

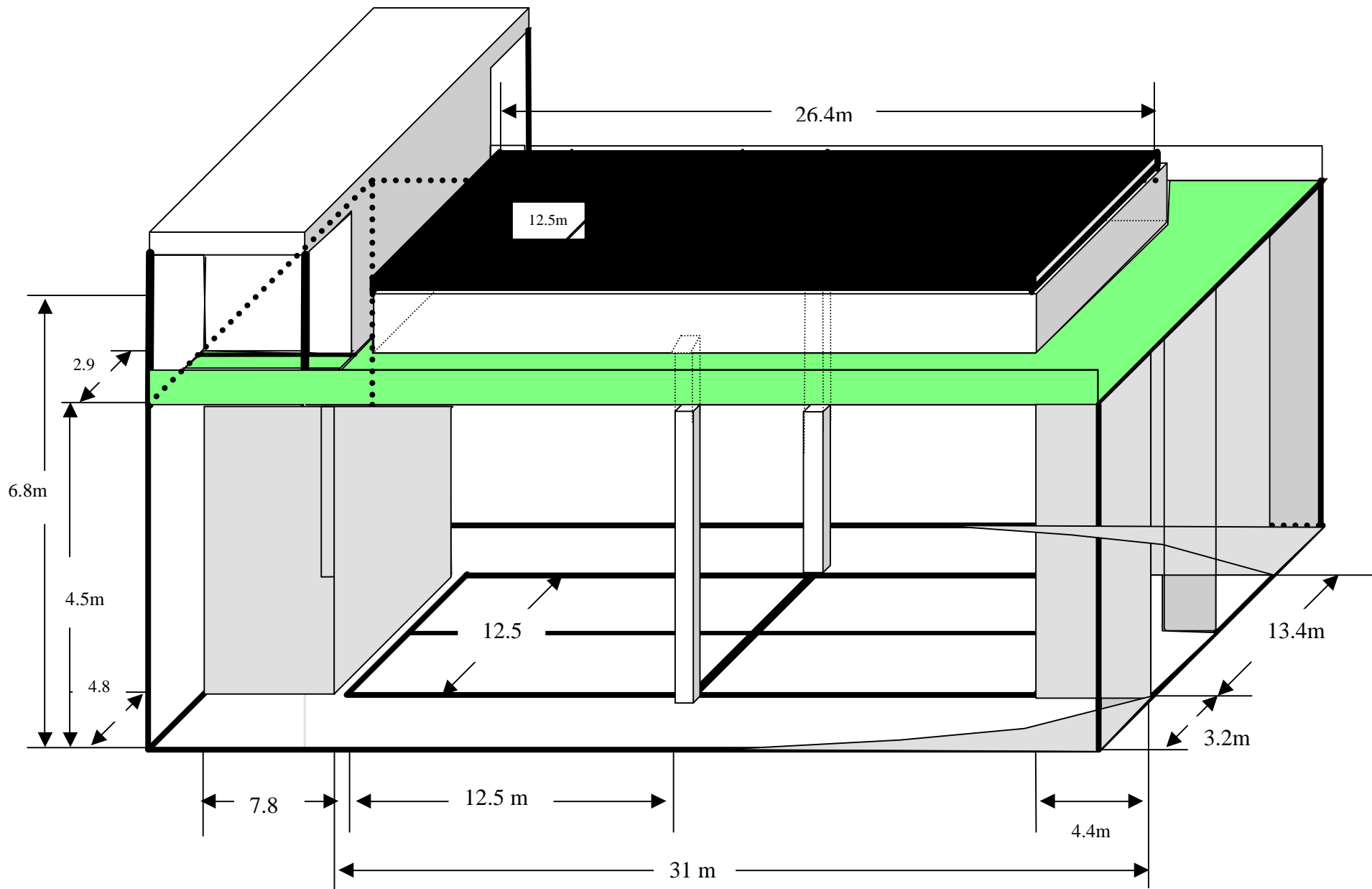

**WEATHER DECK/HATCH COVER/TWEENDECK No2**

**GENERAL VIEW**

**ALL DIMENSIONS ARE ABOUT AND ONLY FOR INFORMATION**

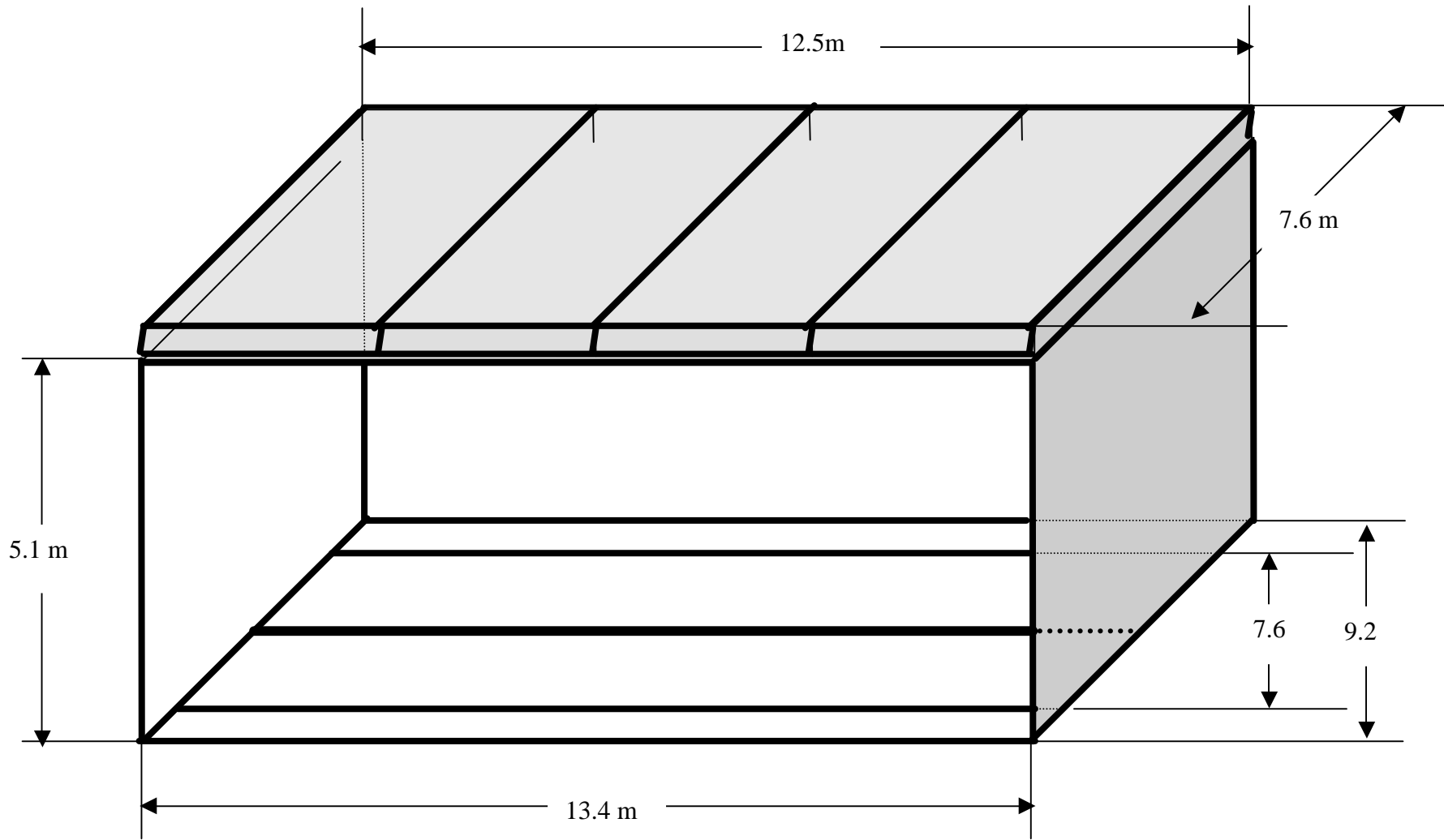

**HATCH COVER AND TWEENDECK No1**

**GENERAL VIEW**

**ALL DIMENSIONS ARE ABOUT AND ONLY FOR INFORMATION**



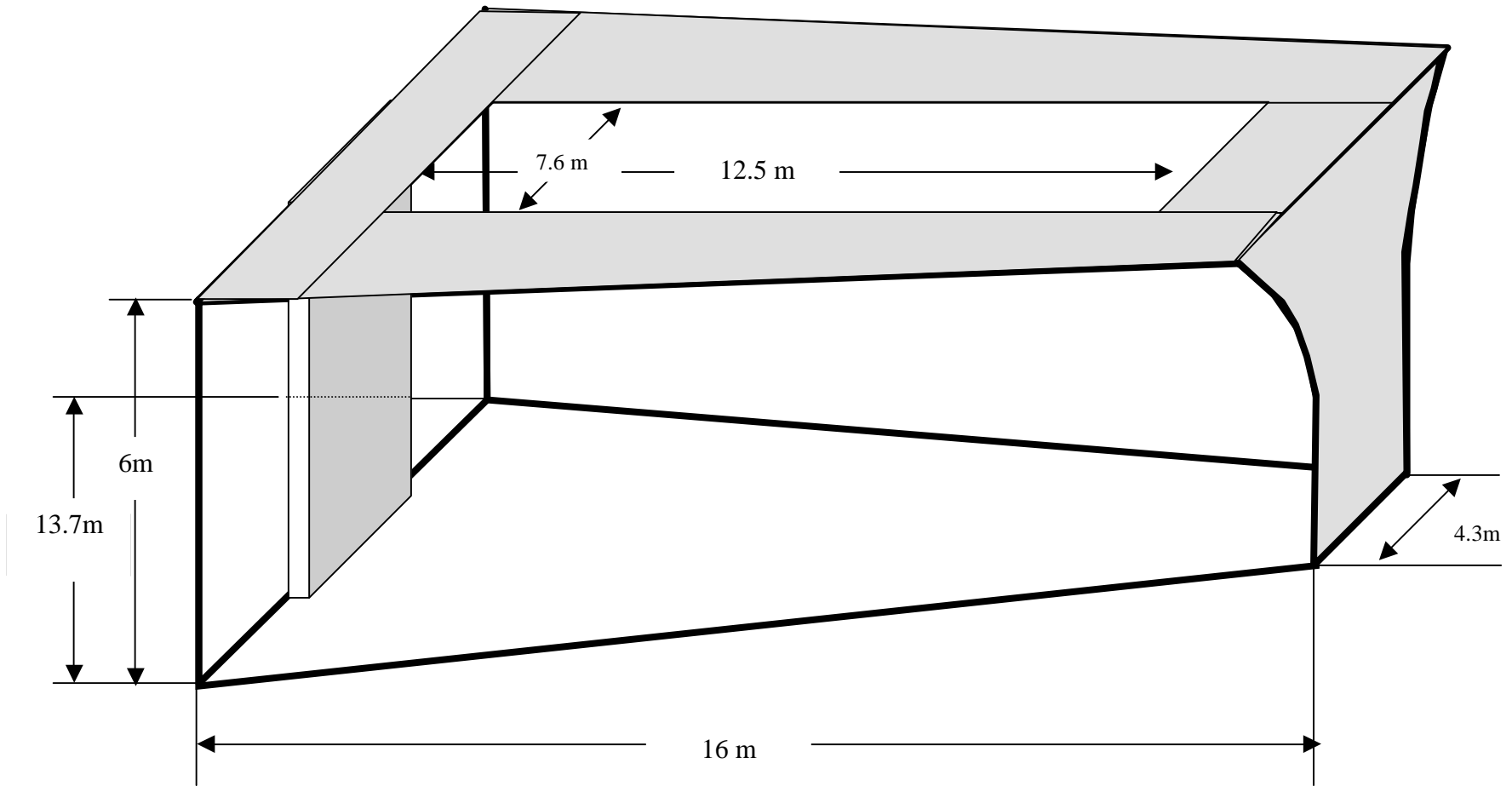

**LOWER HOLD No 1**

**GENERAL VIEW**

**ALL DIMENSIONS ARE ABOUT AND ONLY FOR INFORMATION**

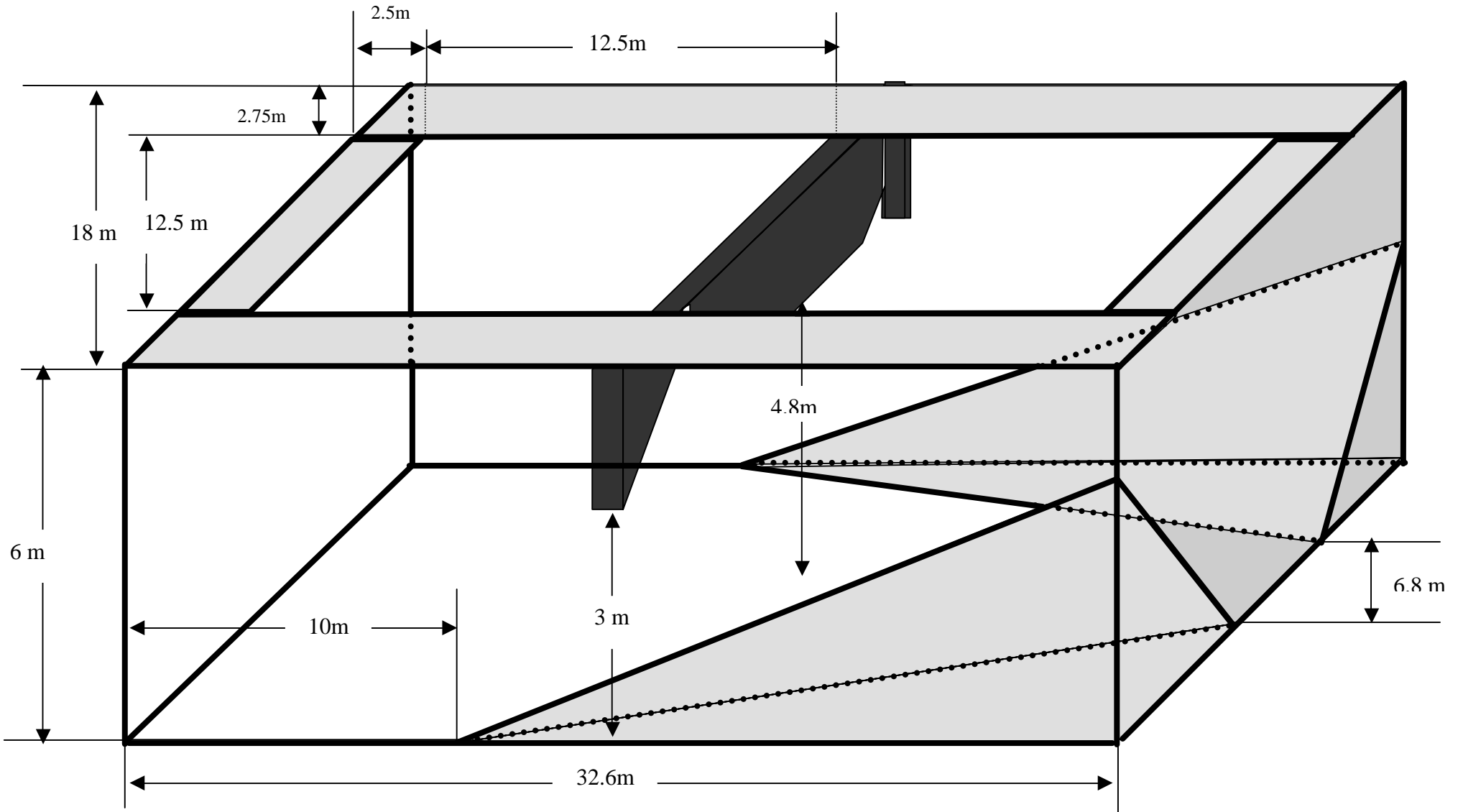

**LOWER HOLD No 2**

**GENERAL VIEW**

**ALL DIMENSIONS ARE ABOUT AND ONLY FOR INFORMATION**

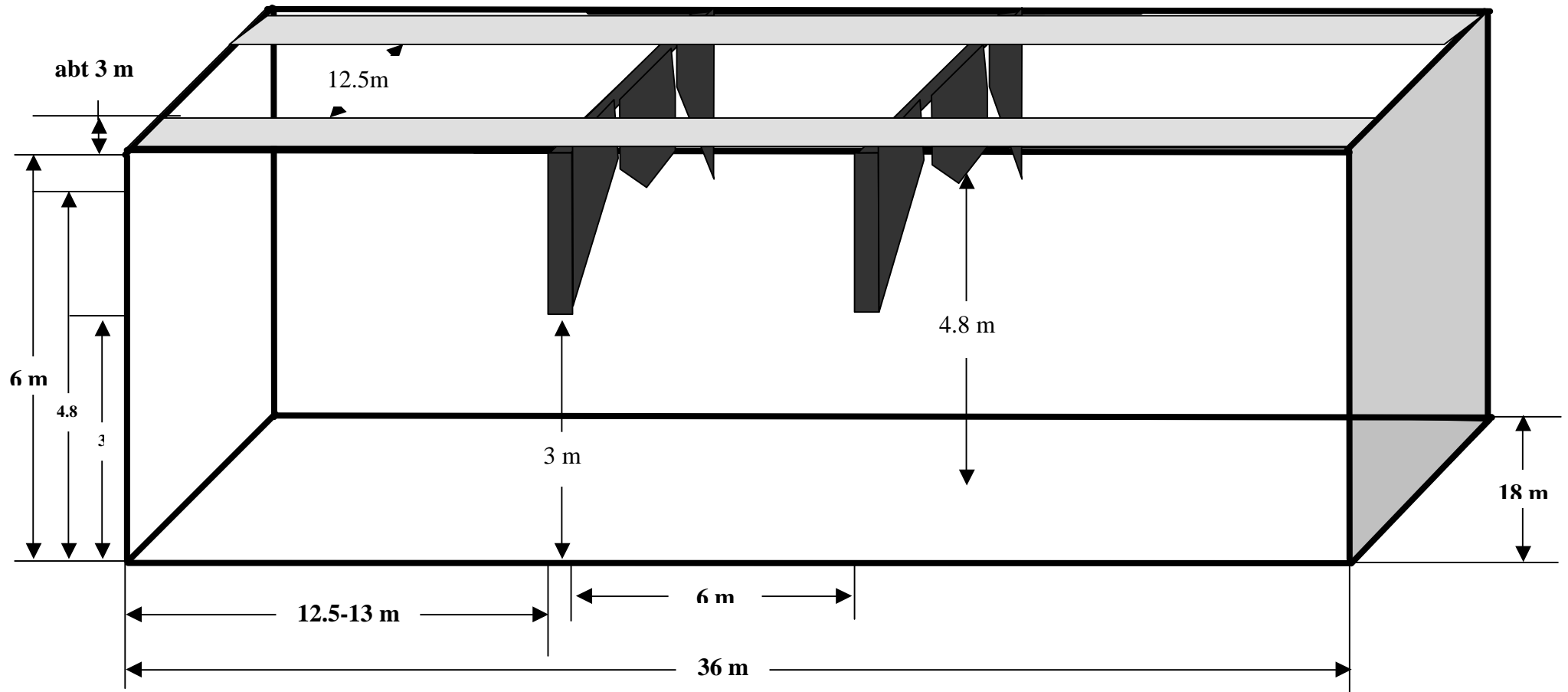

**LOWER HOLD No 3**

**GENERAL VIEW**

**ALL DIMENSIONS ARE ABOUT AND ONLY FOR INFORMATION**

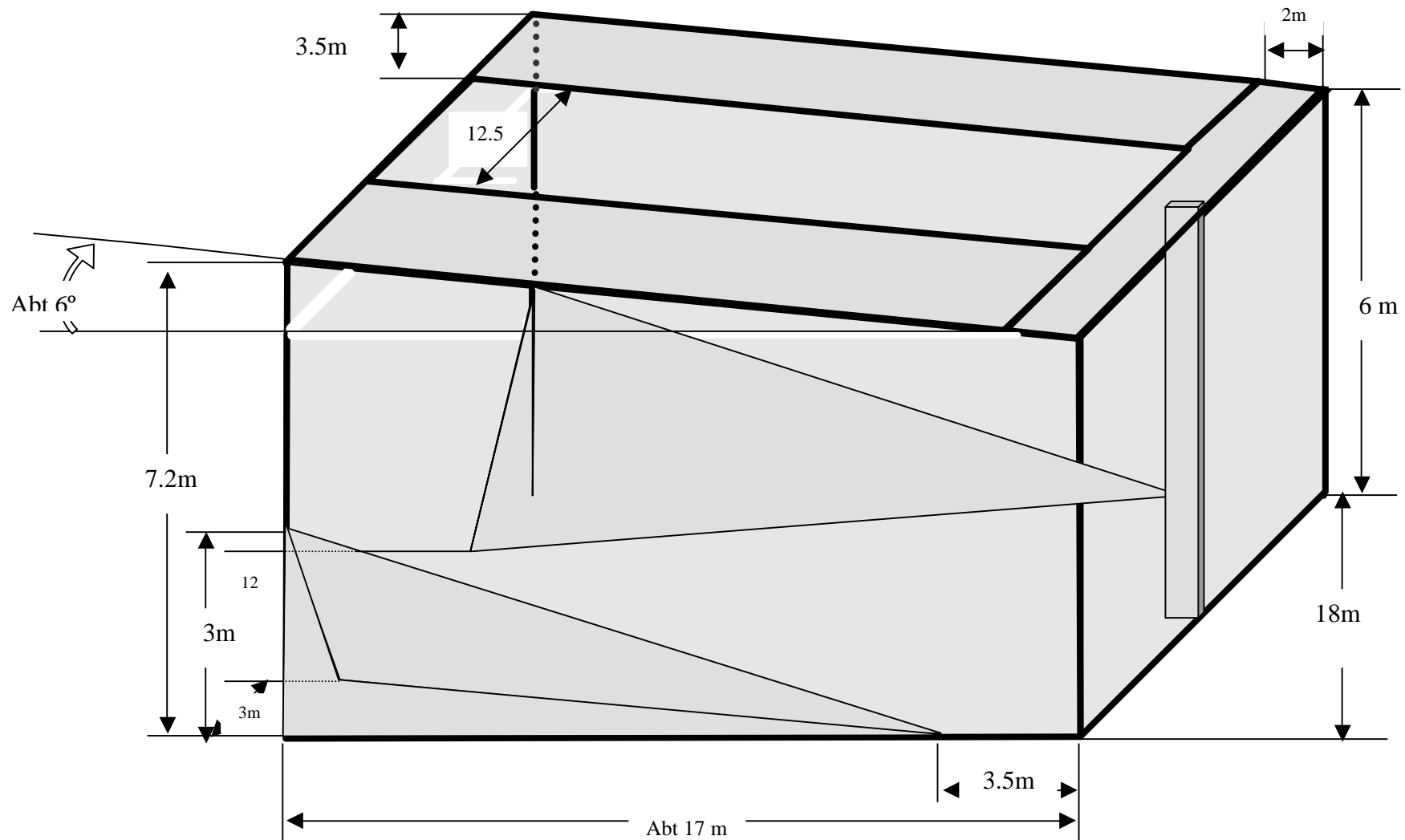

**LOWER HOLD No 4**

**GENERAL VIEW**

**ALL DIMENSIONS ARE ABOUT AND ONLY FOR INFORMATION**